

DS2000

Enclosed automatic unscrewing machine.

Operating speed up to 1,800 products/hour.

Operating principle: the vials or bottles to be unscrewed are placed on a conveyor, then aligned. They are then automatically centered, and the caps unscrewed and removed automatically.



The DS2000 is an automatic capper equipped with:

- Stainless steel frame with «Sécurit» glass enclosure.
- Stainless steel control panel with touch screen.
- Motorized stainless steel conveyor, length: 10 feet (3000 mm), fitted with an acetal pallet chain, width: 82.6 mm.
- Bottle-locking system using a pneumatically-guided cylinder with a cylinder head adapted to the product and position indicator for format changeover.
- Brushless motorized unscrewer.
- Torque adjustment setting on the touch screen.
- The rotation speed of the unscrewing head and the movements can be set and stored on the touch screen.
- Unscrewing device fitted with 3-finger pneumatic gripper.
- Unscrewing unit mounted on a electric cylinder with a brushless motor.
- Machine complies with CE standards.

Available options

- An automatic product feeding system (cylindrical or rectangular infeed table, transfer plate, etc.).
- Increased conveyor width (114 and 190mm).
- An additional gripper for each cap format
- An automatic product reception system at the machine exit (cylindrical or rectangular accumulation table, transfer plate, etc.).

Before placing an order, we can carry out tests free of charge to ensure the feasibility of your project. Please do not hesitate to contact us!

Technical characteristics DS2000

APPROXIMATE MASS (LBS)	880 lbs - 400 kg (depending option)
DIMENSIONS (WITH FRAME)	3 ft - 1005 mm in width 7 ft - 2100 mm in height 10 ft - 3003 mm of depth
POWER CONSUMPTION	1 kW
POWER SUPPLY	208-250 V single phase
FREQUENCY	~ 50 Hz 16 A
CONTROL	by touch screen
IDEAL OPERATING TEMPERATURE	from 50°F to 90°F (10°C to 30°C)

Please note that this machine requires an electrical and pneumatic power supply.

Technical focus n°1

PNEUMATIC / ELECTRICAL CONNECTION

Pneumatic connection: 1 air connection on pressure gauge - Under 6 bars constant (Hose to be provided \varnothing Int/Ext = 8/10 mm).

Electrical connection: 1 Cable 208-250 volts single phase - length 18 ft (6m) - domestic plug to be provided according to your wall outlet.

Technical Focus n°2

TOUCH SCREEN

The color touch screen allows easy adjustment of several parameters such as:

- Selection of functions to be activated

- Timer and parameter settings (pitch, unscrewing speed and torque, etc.).

- Daily product counter

Technical Focus n°3

DISPLAY DEVICE & RACK

The unscrewing device comprises a brushless electric actuator for raising and lowering the unscrewing clamp. The rotation of the clamp is also controlled by a brushless motor. All these movements can be set and stored on the touch screen (position, speed, acceleration, deceleration and torque).

Once the cap has been unscrewed, it is dropped into a drawer which is positioned under the screwing head. It then retracts to evacuate the cap, leaving room for a new cycle.

Technical focus n°4

INDEPENDENT FEEDING / RECEPTION TABLE (for cylindrical bottles only)

This table is installed at the infeed or end of the line to deposit or retrieve vials.

Independent feeding or accumulation table ($\varnothing 27.5"$ (700mm) / $\varnothing 40"$ (1000mm)). It is equipped with :

- HDPE railing
- A frequency inverter to modulate rotation speed
- A guide (adjustable) to bring the products to the conveyor entrance
- "No jam" sensor

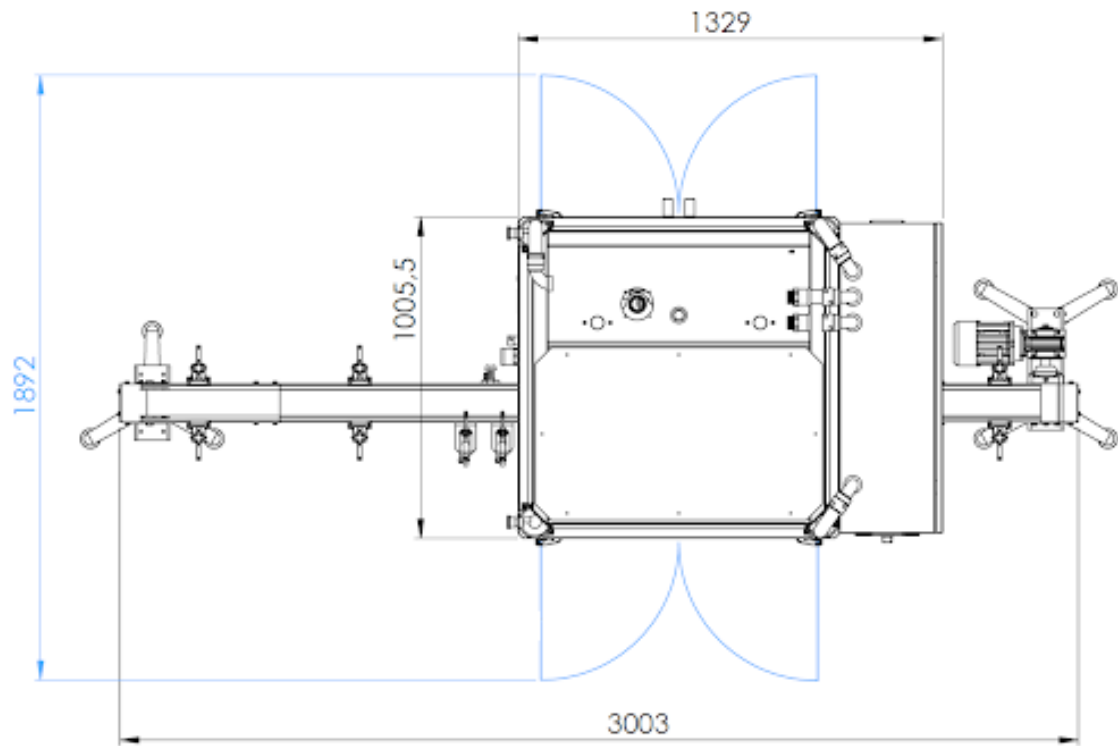

Photos, prices and descriptions are indicative and non-contractual.